



# ARENA

## ZOOMSPOTS

The range is comprised of three models of variable beam 2.0kW or 2.5kW ellipsoidal profile luminaires - Narrow, Medium and Wide. Typically used in medium to large venues for controlled illumination from auditorium and onstage positions. The ellipsoidal optical system provides a high output beam with a centre peak, the light distribution can be adjusted between a flat (2:1) and peak (3:1+) field.

### FEATURES

- Well controlled, ellipsoidal light beam providing leading output in a very even field.
- Narrow 9°-18°, Medium 14°-32° and Wide 20°-37°.
- Interchangeable lens trays between Medium and Wide luminaires.
- Rotatable pattern holder, to align pattern projections on stage with out having to adjust the luminaire.
- Infinite range of masking angles provided by two plane rotatable shutter system.
- Cranked yoke with adjustable balance point.
- 'Swing-down' door for easy access to lamp or cleaning. Isolates the mains supply when opened.
- Choice of GY16 lamp socket for CP72, 2.0kW lamp or G22 lamp socket for CP91, 2.5kW or CP92, 2.0kW lamp.
- Smooth focus movement from 'Posi-slide' focus system, no metal to metal contact.
- Fully tested and compliant to CE standards.

### PHYSICAL DATA

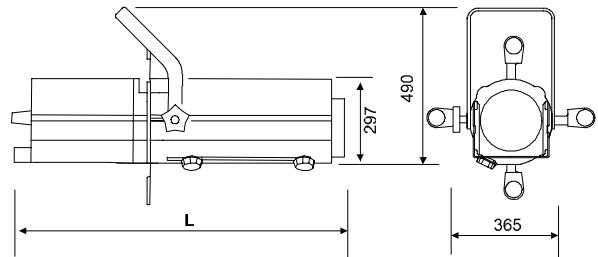

	9°-18°	14°-32°	20°-37°
<b>Length:</b>	1170mm	960mm	960mm
<b>Weight:</b>	20.3kg	19.7kg	19.7kg
<b>Packed:</b>	23.0kg	22.5kg	22.5kg
<b>Cubic:</b>	0.175	0.144	0.144

**Colour Frame Size:** 245mm x 245mm – medium & wide  
245mm x 310 for narrow

**Pattern size:** A

**Included:** 4 shutters, 1 colour frame, 1 M12 nut & bolt set, instruction leaflet.

### LAMPS: 220V-240V

#### GY16 lamp socket / 2000W

CP72 50,000 lumens 400 hours average life

#### G22 lamp socket / 2500W

CP91 65,000 lumens 400 hours average life

#### G22 lamp socket / 2000W

CP92 50,000 lumens 400 hours average life

### PHOTOMETRIC DATA

Arena Zoomspot 9°-18°, 14°-32°, 20°-37°										
Beam diameter in metres										
Beam angle		0	0.63	1.26	1.89	2.52	3.15	3.78	4.41	5.04
9°	0	0.63	1.26	1.89	2.52	3.15	3.78	4.41	5.04	5.67
18°	0	1.27	2.53	3.80	5.07	6.34	7.60	8.87	10.14	11.41
14°	0	0.98	1.96	2.95	3.93	4.91	5.89	6.88	7.86	8.85
32°	0	2.29	4.59	6.88	9.18	11.47	13.76	16.06	18.35	20.64
20°	0	1.41	2.82	4.23	5.64	7.05	8.46	9.87	11.28	12.69
37°	0	2.68	5.35	8.03	10.71	13.38	16.06	18.74	21.41	24.09

Light Output in Lux										
Lamp	Beam angle	0	0.63	1.26	1.89	2.52	3.15	3.78	4.41	5.04
CP91 2500W	9°	Peak	41312	10328	4590	2582	1652	1148	843	646
		Flat	38281	9570	4253	2393	1531	1063	781	598
	18°	Peak	25113	6278	2790	1570	1005	698	513	392
		Flat	19906	4977	2212	1244	796	553	406	311
	14°	Peak	31841	7960	3538	1990	1274	884	650	498
		Flat	28481	7120	3165	1780	1139	791	581	445
	32°	Peak	9647	2412	1072	603	386	268	-	-
		Flat	7656	1914	851	479	306	213	-	-
	20°	Peak	18681	4670	2076	1169	747	519	391	292
		Flat	17150	4288	1906	1072	686	476	350	268
	37°	Peak	7778	1945	864	486	311	-	-	-
		Flat	6125	1531	681	383	245	-	-	-

Tests conducted using a standard CP91, 2500W, 240V, 65,600 lumens lamp.

### ORDER CODES & ACCESSORIES

Arena Zoomspot Narrow - GY16	10AZS2000N
Arena Zoomspot Narrow - G22	10AZS2500M
Arena Zoomspot Medium - GY16	10AZS2000M
Arena Zoomspot Medium - G22	10AZS2500M
Arena Zoomspot Wide - GY16	10AZS2000W
Arena Zoomspot Wide - G22	10AZS2500W
Iris	20IRIS
Rotatable Pattern Holder	20AZGH
Arena Medium Lens tray 14-32	20ALAM
Arena Wide Lens tray 20-37	20ALAW
Lens Safety Mesh Narrow	20SM25
Lens Safety Mesh Medium & Wide	20SM20
Suspension Hookclamp	20HC
Safety Bond	20SC

Selecon reserves the right to change the specifications without notice (09/06).